

**Please read all instructions** and watch the “How to” video on our website [www.phonewear360.com](http://www.phonewear360.com) prior to use.

## Step 1 INSTRUCTIONS

### Attaching sleeve piece to back of phone case or to back of phone

**Follow these instructions only if you did not purchase a case with your device.**

Using sandpaper (provided), *lightly* sand the center area on the back of your phone case or back of your phone. After sanding, use the alcohol pad (provided) to clean back of phone case or back of phone before adhering sleeve to your phone case or to your phone. Gently peel film off adhesive tape (provided) on back of sleeve piece and firmly press onto back of phone case or back of phone. See pictures below. See Website video. See Step 2

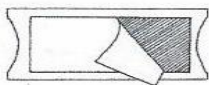

Peel film off of Sleeve piece



Sand and clean back of case or back of phone

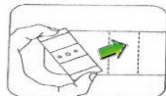

Adhere Sleeve piece to the back of case or back of phone. Center!

## Step 2 ARMBAND INSTRUCTION

**Follow these instructions if you purchased a case with your device.**

Strap the Phone Wear 360™ armband device to desired area of arm and secure Velcro® band. Place your Phone or I pod into the case. Carefully slide sleeve piece onto dial piece and make sure it clicks into the slots on the side of sleeve piece. See pictures below. See Website Video.

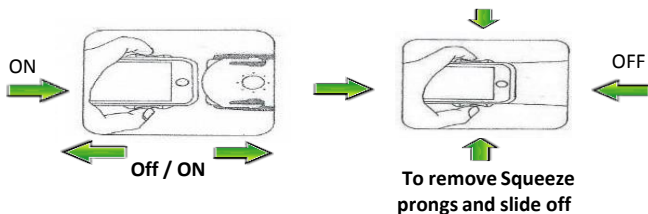

**Always place strap on first before attaching phone.** Wrap security band around phone and secure Velcro® to armband. **Always wear security strap when using device during active movement** See website video.

***Neither Phone Wear 360™, nor GJB Internet Holdings, LLC, its subsidiaries or employees, vendors, retailers, etc., shall be held responsible for any damages to phones, Ipods, phone cases, or any device while using this product. Wearer assumes all risks associated with use. Please follow all instructions prior to use. This is not a toy and should be kept away from small children. Choking hazard! NEVER TEXT WHILE DRIVING!***

**ENJOY!**

See website for Limited Warranty. [www.phonewear360.com](http://www.phonewear360.com) Velcro® is a registered trademark. All rights reserved. Cases made in China. Phone Wear 360™ Armband proudly made and assembled in USA. Some assembly required.

## PHONE WEAR 360<sup>o</sup>™ ADDITIONAL INSTRUCTIONS

Please read all instructions prior to use.

***Never Text while driving!***

**NEVER** squeeze the side tabs to rotate the dial piece. This may cause the piece to break. See figure 1.



Fig. 1

Rotate your dial piece by using a flat palm or by placing your fingers on outer solid edges of the dial piece. See figures 2 & 3.



Fig. 2



Fig. 3

**ALWAYS** wear your Phone Wear 360<sup>o</sup>™ armband with the security strap in place. This provides added protection during active motion. Such as walking/running. See figure 4.



Fig. 4

See our website for additional instructions. Visit:

[www.phonewear360.com](http://www.phonewear360.com) Also see back of package insert.